

- 09_ Floor finish
- 08_ UFH compatible underlay
- 07_ Floor sensor (conduit recommended)*
- 06_ Warmup Diffusion Plate
- 05_ Warmup 16 mm pipework
- 04_ Warmup Contura Panel
- 03_ 8 mm Warmup perimeter strip
- 02_ DPM
- 01_ Subfloor to SR1 standard

REV	DATE	DESCRIPTION	DR	CH



Warmup

The world's **best-selling** floor heating brand™

WARMUP PLC, 704 Tudor Estate, Abbey Road, London, NW10 7UW
 Tel 0845 034 8270 Fax 0208 453 6869
cad@warmup.com projects@warmup.com www.warmup.co.uk

DRAWING ISSUE STATUS		DRAWING NO
CONSTRUCTION		01
PROJECT		
CONTURA FLOATING FLOOR SYSTEM		
CONCRETE SUBFLOOR		
TITLE		
GENERIC TEMPLATE		
DETAILED SECTION		
PROJECT MANAGER	DRAWN	CHECKED
	AA	AW
DATE	SCALE	REVISION
21.02.2017	1:50@A3	
CAD FILE		
20170221-H-CONTURA-DET SECTIONS.DWG		

WARMUP CONTURA FLOATING FLOOR SYSTEM. Concrete subfloor. Generic template

* The aluminium plates should be trimmed to allow 50mm spacing between the sensor and the diffuser plates.

© This drawing is confidential and may not be used, copied or disclosed to anyone without permission of Warmup Plc. The Copyright of these drawings remain the property of Warmup Plc.

Do not scale from drawings, all dimensions to be checked on site.

The Warmup word and associated logos are trade marks. © Warmup Plc. 2010 - Regd. TM Nos. 1257757, 4409926, 5265707. E & OE. Registered in England No. 2955213.

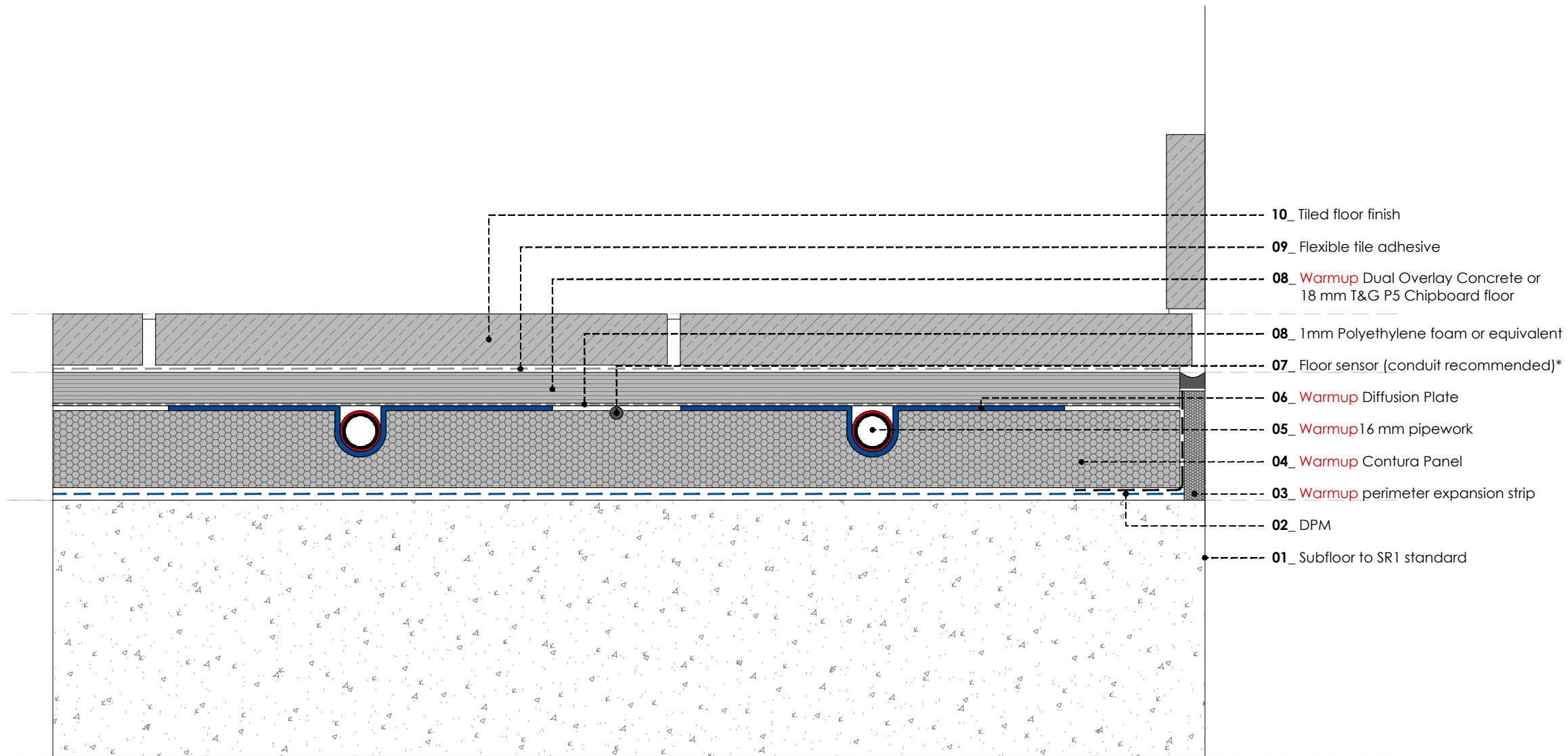

- 10_ Tiled floor finish
- 09_ Flexible tile adhesive
- 08_ Warmup Dual Overlay Concrete or 18 mm T&G P5 Chipboard floor
- 08_ 1mm Polyethylene foam or equivalent
- 07_ Floor sensor (conduit recommended)*
- 06_ Warmup Diffusion Plate
- 05_ Warmup 16 mm pipework
- 04_ Warmup Contura Panel
- 03_ Warmup perimeter expansion strip
- 02_ DPM
- 01_ Subfloor to SR1 standard

REV	DATE	DESCRIPTION	DR	CH



Warmup

The world's **best-selling** floor heating brand™

WARMUP PLC, 704 Tudor Estate, Abbey Road, London, NW10 7UW
 Tel 0845 034 8270 Fax 0208 453 6869
cad@warmup.com projects@warmup.com www.warmup.co.uk

DRAWING ISSUE STATUS		DRAWING NO
CONSTRUCTION		02
PROJECT		
CONTURA FLOATING FLOOR SYSTEM		
CONCRETE SUBFLOOR		
TITLE		
TILED FLOOR		
DETAILED SECTION		
PROJECT MANAGER	DRAWN	CHECKED
	AA	AW
DATE	SCALE	REVISION
21.02.2017	1:50@A3	
CAD FILE		
20170221-H-CONTURA-DET SECTIONS.DWG		

WARMUP CONTURA FLOATING FLOOR SYSTEM. Concrete subfloor. Tiled floor

* The aluminium plates should be trimmed to allow 50mm spacing between the sensor and the diffuser plates.

© This drawing is confidential and may not be used, copied or disclosed to anyone without permission of Warmup Plc. The Copyright of these drawings remain the property of Warmup Plc.

Do not scale from drawings, all dimensions to be checked on site.

The Warmup word and associated logos are trade marks. © Warmup Plc. 2010 - Regd. TM Nos. 1257757, 4409926, 5265707. E & OE. Registered in England No. 2955213.

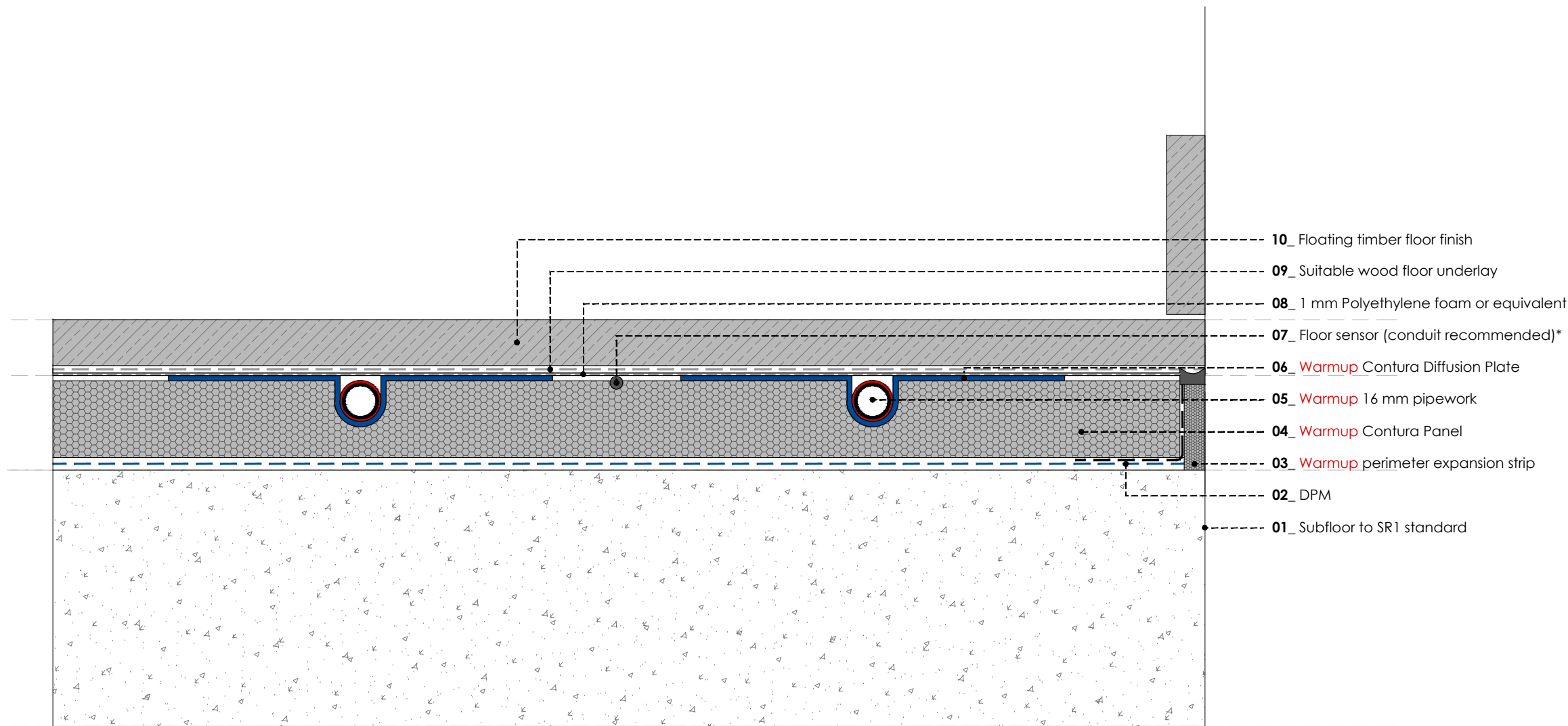

- 10_ Floating timber floor finish
- 09_ Suitable wood floor underlay
- 08_ 1 mm Polyethylene foam or equivalent
- 07_ Floor sensor (conduit recommended)*
- 06_ Warmup Contura Diffusion Plate
- 05_ Warmup 16 mm pipework
- 04_ Warmup Contura Panel
- 03_ Warmup perimeter expansion strip
- 02_ DPM
- 01_ Subfloor to SR1 standard

REV	DATE	DESCRIPTION	DR	CH



Warmup

The world's **best-selling** floor heating brand™

WARMUP PLC, 704 Tudor Estate, Abbey Road, London, NW10 7UW
 Tel 0845 034 8270 Fax 0208 453 6869
cad@warmup.com projects@warmup.com www.warmup.co.uk

DRAWING ISSUE STATUS		DRAWING NO
CONSTRUCTION		03
PROJECT		
CONTURA FLOATING FLOOR SYSTEM		
CONCRETE SUBFLOOR		
TITLE		
WOOD / LAMINATE FLOOR - FLOATING		
DETAILED SECTION		
PROJECT MANAGER	DRAWN	CHECKED
	AA	AW
DATE	SCALE	REVISION
21.02.2017	1:50@A3	
CAD FILE		
20170221-H-CONTURA-DET SECTIONS.DWG		

WARMUP CONTURA FLOATING FLOOR SYSTEM. Concrete subfloor. 14-25 mm Wood / Laminate floor - floating

* The aluminium plates should be trimmed to allow 50mm spacing between the sensor and the diffuser plates.

© This drawing is confidential and may not be used, copied or disclosed to anyone without permission of Warmup Plc. The Copyright of these drawings remain the property of Warmup Plc.

Do not scale from drawings, all dimensions to be checked on site.

The Warmup word and associated logos are trade marks. © Warmup Plc. 2010 - Regd. TM Nos. 1257757, 4409926, 5265707. E & OE. Registered in England No. 2955213.

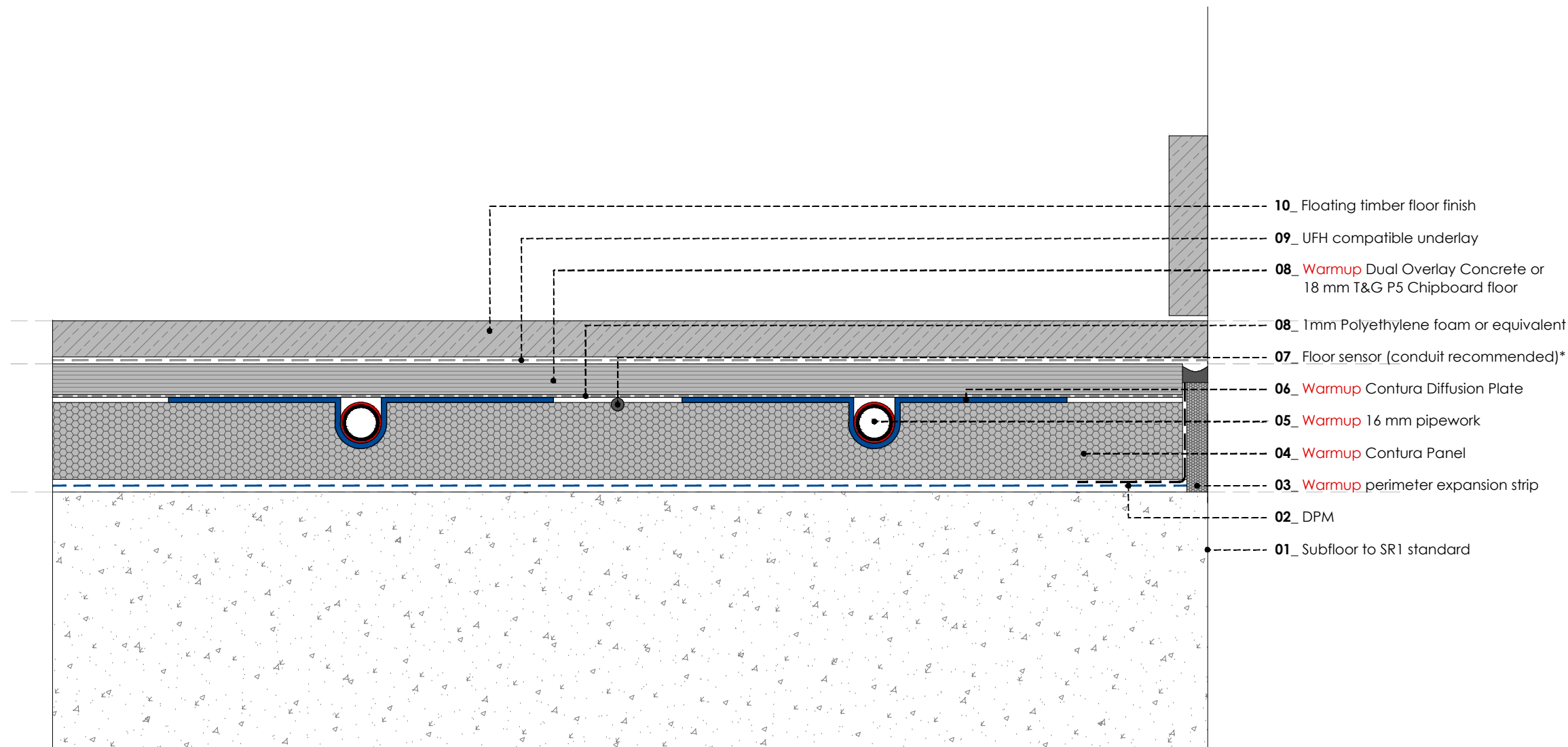

- 10_ Floating timber floor finish
- 09_ UFH compatible underlay
- 08_ Warmup Dual Overlay Concrete or 18 mm T&G P5 Chipboard floor
- 08_ 1mm Polyethylene foam or equivalent
- 07_ Floor sensor (conduit recommended)*
- 06_ Warmup Contura Diffusion Plate
- 05_ Warmup 16 mm pipework
- 04_ Warmup Contura Panel
- 03_ Warmup perimeter expansion strip
- 02_ DPM
- 01_ Subfloor to SR1 standard

REV	DATE	DESCRIPTION	DR	CH



Warmup

The world's best-selling floor heating brand™

WARMUP PLC, 704 Tudor Estate, Abbey Road, London, NW10 7UW
 Tel 0845 034 8270 Fax 0208 453 6869
cad@warmup.com projects@warmup.com www.warmup.co.uk

DRAWING ISSUE STATUS		DRAWING NO
CONSTRUCTION		04
PROJECT		
CONTURA FLOATING FLOOR SYSTEM		
CONCRETE SUBFLOOR		
TITLE		
WOOD/LAMINATE FLOOR(14mm)-FLOATING		
DETAILED SECTION		
PROJECT MANAGER	DRAWN	CHECKED
	AA	AW
DATE	SCALE	REVISION
21.02.2017	1:50@A3	
CAD FILE		
20170221-H-CONTURA-DET SECTIONS.DWG		

WARMUP CONTURA FLOATING FLOOR SYSTEM. Concrete subfloor. Wood / Laminate floor less than 14 mm - Floating

* The aluminium plates should be trimmed to allow 50mm spacing between the sensor and the diffuser plates.

© This drawing is confidential and may not be used, copied or disclosed to anyone without permission of Warmup Plc. The Copyright of these drawings remain the property of Warmup Plc.

Do not scale from drawings, all dimensions to be checked on site.

The Warmup word and associated logos are trade marks. © Warmup Plc. 2010 - Regd. TM Nos. 1257757, 4409926, 5265707. E & OE. Registered in England No. 2955213.

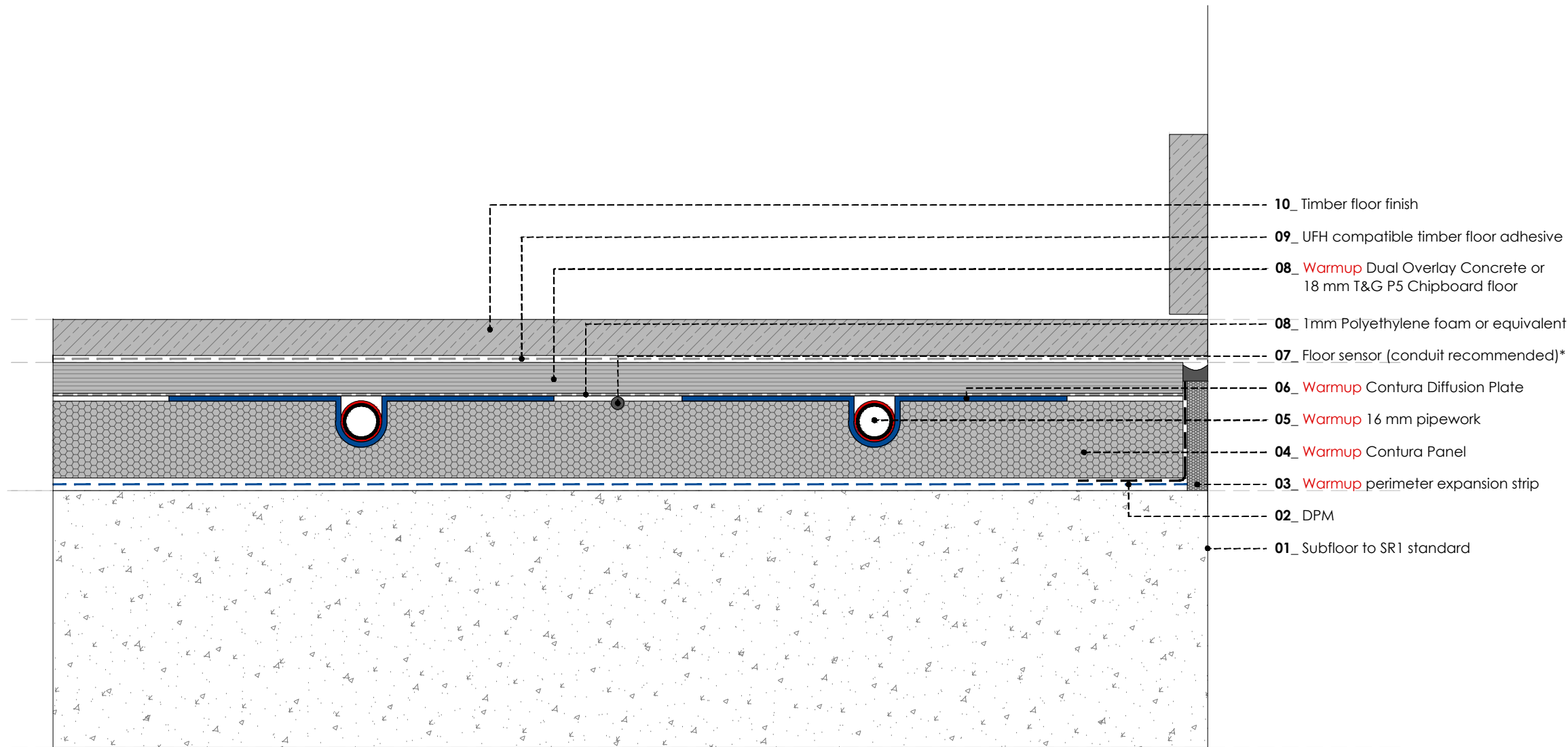

- 10_ Timber floor finish
- 09_ UFH compatible timber floor adhesive
- 08_ Warmup Dual Overlay Concrete or 18 mm T&G P5 Chipboard floor
- 08_ 1mm Polyethylene foam or equivalent
- 07_ Floor sensor (conduit recommended)*
- 06_ Warmup Contura Diffusion Plate
- 05_ Warmup 16 mm pipework
- 04_ Warmup Contura Panel
- 03_ Warmup perimeter expansion strip
- 02_ DPM
- 01_ Subfloor to SR1 standard

REV	DATE	DESCRIPTION	DR	CH



Warmup

The world's **best-selling** floor heating brand™

WARMUP PLC, 704 Tudor Estate, Abbey Road, London, NW10 7UW
 Tel 0845 034 8270 Fax 0208 453 6869
cad@warmup.com projects@warmup.com www.warmup.co.uk

DRAWING ISSUE STATUS		DRAWING NO
CONSTRUCTION		05
PROJECT		
CONTURA FLOATING FLOOR SYSTEM		
CONCRETE SUBFLOOR		
TITLE		
WOOD / LAMINATE FLOOR - GLUED		
DETAILED SECTION		
PROJECT MANAGER	DRAWN	CHECKED
	AA	AW
DATE	SCALE	REVISION
21.02.2017	1:50@A3	
CAD FILE		
20170221-H-CONTURA-DET SECTIONS.DWG		

WARMUP CONTURA FLOATING FLOOR SYSTEM. Concrete subfloor. Wood / Laminate floor - glued

* The aluminium plates should be trimmed to allow 50mm spacing between the sensor and the diffuser plates.

© This drawing is confidential and may not be used, copied or disclosed to anyone without permission of Warmup Plc. The Copyright of these drawings remain the property of Warmup Plc.

Do not scale from drawings, all dimensions to be checked on site.
 The Warmup word and associated logos are trade marks. © Warmup Plc. 2010 - Regd. TM Nos. 1257757, 4409926, 5265707. E & OE. Registered in England No. 2955213.

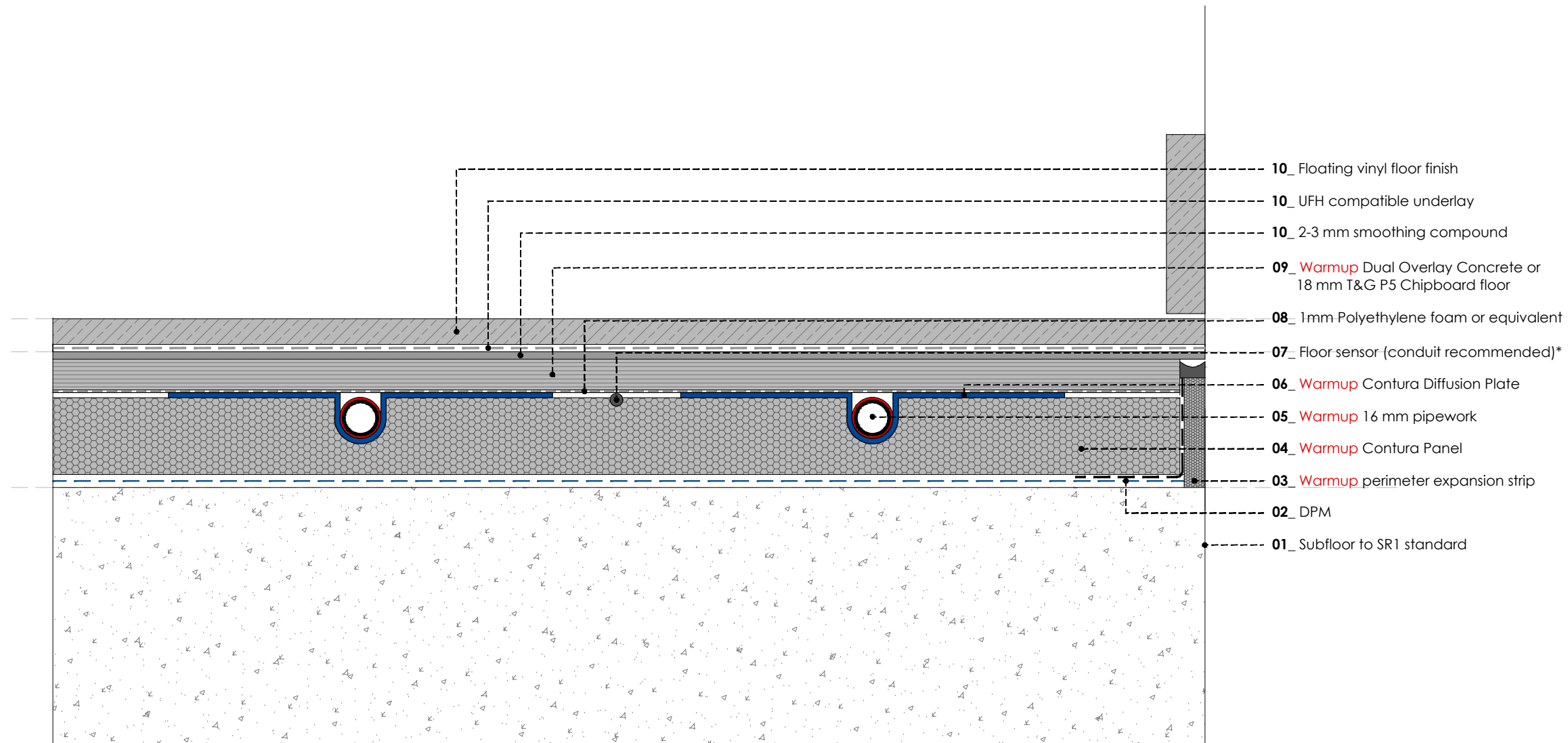

- 10_ Floating vinyl floor finish
- 10_ UFH compatible underlay
- 10_ 2-3 mm smoothing compound
- 09_ Warmup Dual Overlay Concrete or 18 mm T&G P5 Chipboard floor
- 08_ 1mm Polyethylene foam or equivalent
- 07_ Floor sensor (conduit recommended)*
- 06_ Warmup Contura Diffusion Plate
- 05_ Warmup 16 mm pipework
- 04_ Warmup Contura Panel
- 03_ Warmup perimeter expansion strip
- 02_ DPM
- 01_ Subfloor to SR1 standard

REV	DATE	DESCRIPTION	DR	CH



Warmup

The world's best-selling floor heating brand™

WARMUP PLC, 704 Tudor Estate, Abbey Road, London, NW10 7UW
 Tel 0845 034 8270 Fax 0208 453 6869
cad@warmup.com projects@warmup.com www.warmup.co.uk

DRAWING ISSUE STATUS		DRAWING NO
CONSTRUCTION		06
PROJECT		
CONTURA FLOATING FLOOR SYSTEM		
CONCRETE SUBFLOOR		
TITLE		
VINYL FLOOR - FLOATING		
DETAILED SECTION		
PROJECT MANAGER	DRAWN	CHECKED
	AA	AW
DATE	SCALE	REVISION
21.02.2017	1:50@A3	
CAD FILE		
20170221-H-CONTURA-DET SECTIONS.DWG		

WARMUP CONTURA FLOATING FLOOR SYSTEM. Concrete subfloor. Vinyl floor - floating

* The aluminium plates should be trimmed to allow 50mm spacing between the sensor and the diffuser plates.

© This drawing is confidential and may not be used, copied or disclosed to anyone without permission of Warmup Plc. The Copyright of these drawings remain the property of Warmup Plc.

Do not scale from drawings, all dimensions to be checked on site.

The Warmup word and associated logos are trade marks. © Warmup Plc. 2010 - Regd. TM Nos. 1257757, 4409926, 5265707. E & OE. Registered in England No. 2955213.

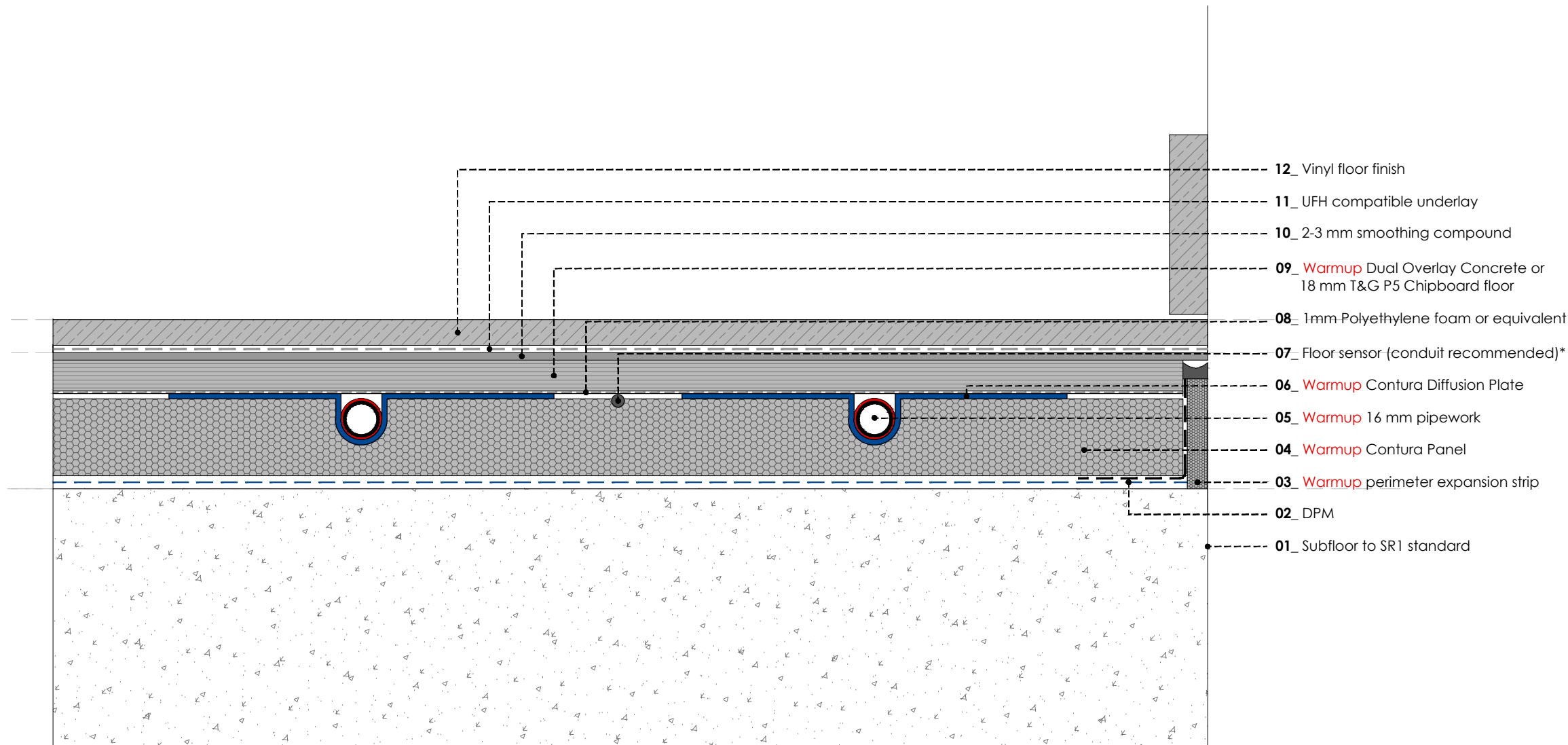

- 12_ Vinyl floor finish
- 11_ UFH compatible underlay
- 10_ 2-3 mm smoothing compound
- 09_ Warmup Dual Overlay Concrete or 18 mm T&G P5 Chipboard floor
- 08_ 1mm Polyethylene foam or equivalent
- 07_ Floor sensor (conduit recommended)*
- 06_ Warmup Contura Diffusion Plate
- 05_ Warmup 16 mm pipework
- 04_ Warmup Contura Panel
- 03_ Warmup perimeter expansion strip
- 02_ DPM
- 01_ Subfloor to SR1 standard

REV	DATE	DESCRIPTION	DR	CH



Warmup

The world's **best-selling** floor heating brand™

WARMUP PLC, 704 Tudor Estate, Abbey Road, London, NW10 7UW
 Tel 0845 034 8270 Fax 0208 453 6869
cad@warmup.com projects@warmup.com www.warmup.co.uk

DRAWING ISSUE STATUS		DRAWING NO
CONSTRUCTION		07
PROJECT		
CONTURA FLOATING FLOOR SYSTEM		
CONCRETE SUBFLOOR		
TITLE		
VINYL FLOOR - GLUED		
DETAILED SECTION		
PROJECT MANAGER	DRAWN	CHECKED
	AA	AW
DATE	SCALE	REVISION
21.02.2017	1:50@A3	
CAD FILE		
20170221-H-CONTURA-DET SECTIONS.DWG		

WARMUP CONTURA FLOATING FLOOR SYSTEM. Concrete subfloor. Vinyl floor - glued

* The aluminium plates should be trimmed to allow 50mm spacing between the sensor and the diffuser plates.

© This drawing is confidential and may not be used, copied or disclosed to anyone without permission of Warmup Plc. The Copyright of these drawings remain the property of Warmup Plc.

Do not scale from drawings, all dimensions to be checked on site.

The Warmup word and associated logos are trade marks. © Warmup Plc. 2010 - Regd. TM Nos. 1257757, 4409926, 5265707. E & OE. Registered in England No. 2955213.

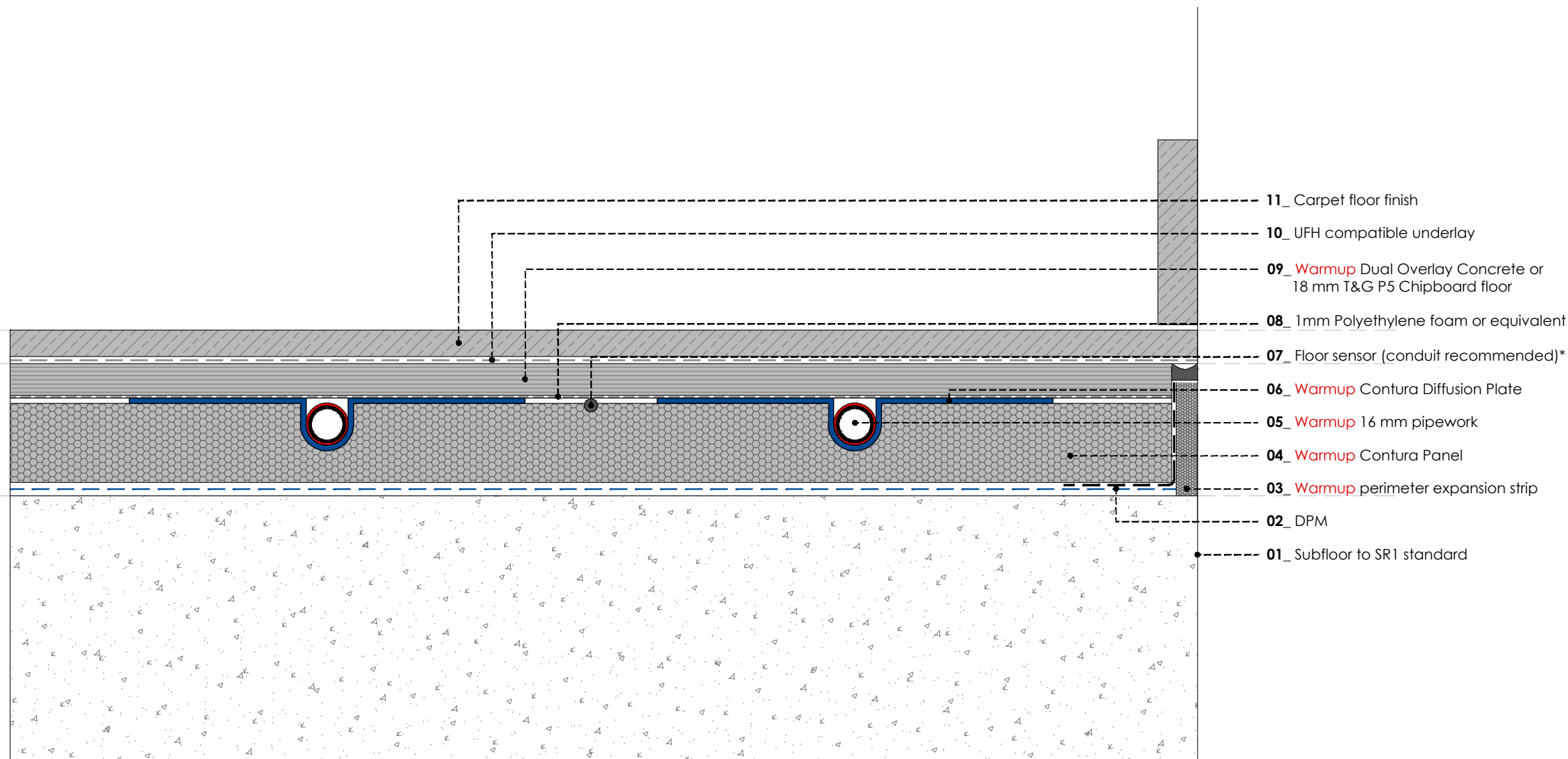

- 11_ Carpet floor finish
- 10_ UFH compatible underlay
- 09_ Warmup Dual Overlay Concrete or 18 mm T&G P5 Chipboard floor
- 08_ 1mm Polyethylene foam or equivalent
- 07_ Floor sensor (conduit recommended)*
- 06_ Warmup Contura Diffusion Plate
- 05_ Warmup 16 mm pipework
- 04_ Warmup Contura Panel
- 03_ Warmup perimeter expansion strip
- 02_ DPM
- 01_ Subfloor to SR1 standard

REV	DATE	DESCRIPTION	DR	CH



Warmup

The world's best-selling floor heating brand™

WARMUP PLC, 704 Tudor Estate, Abbey Road, London, NW10 7UW
 Tel 0845 034 8270 Fax 0208 453 6869
cad@warmup.com projects@warmup.com www.warmup.co.uk

DRAWING ISSUE STATUS		DRAWING NO
CONSTRUCTION		08
PROJECT		
CONTURA FLOATING FLOOR SYSTEM		
CONCRETE SUBFLOOR		
TITLE		
CARPET FLOOR		
DETAILED SECTION		
PROJECT MANAGER	DRAWN	CHECKED
	AA	AW
DATE	SCALE	REVISION
21.02.2017	1:50@A3	
CAD FILE		
20170221-H-CONTURA-DET SECTIONS.DWG		

WARMUP CONTURA FLOATING FLOOR SYSTEM. Concrete subfloor. Carpet floor

* The aluminium plates should be trimmed to allow 50mm spacing between the sensor and the diffuser plates.

© This drawing is confidential and may not be used, copied or disclosed to anyone without permission of Warmup Plc. The Copyright of these drawings remain the property of Warmup Plc.

Do not scale from drawings, all dimensions to be checked on site.

The Warmup word and associated logos are trade marks. © Warmup Plc. 2010 - Regd. TM Nos. 1257757, 4409926, 5265707. E & OE. Registered in England No. 2955213.