

REV	DATE	DESCRIPTION	DR	CH



Warmup

The world's **best-selling** floor heating brand™

WARMUP PLC, 704 Tudor Estate, Abbey Road, London, NW10 7UW
 Tel 0845 034 8270 Fax 0208 453 6869
cad@warmup.com projects@warmup.com www.warmup.co.uk

DRAWING ISSUE STATUS		DRAWING NO
CONSTRUCTION		01
PROJECT		
FORTE GRID SYSTEM CONCRETE SUBFLOOR		
TITLE		
GENERIC TEMPLATE DETAILED SECTION		
PROJECT MANAGER	DRAWN	CHECKED
	AA	AW
DATE	SCALE	REVISION
21.02.2017	1:50@A3	
CAD FILE		
20170221-H-FORTE-DET SECTIONS.DWG		

WARMUP FORTE GRID SYSTEM. Generic template

© This drawing is confidential and may not be used, copied or disclosed to anyone without permission of Warmup Plc. The Copyright of these drawings remain the property of Warmup Plc.

Do not scale from drawings, all dimensions to be checked on site.

The Warmup word and associated logos are trade marks. © Warmup Plc. 2010 - Regd. TM Nos. 1257757, 4409926, 5265707. E & OE. Registered in England No. 2955213.

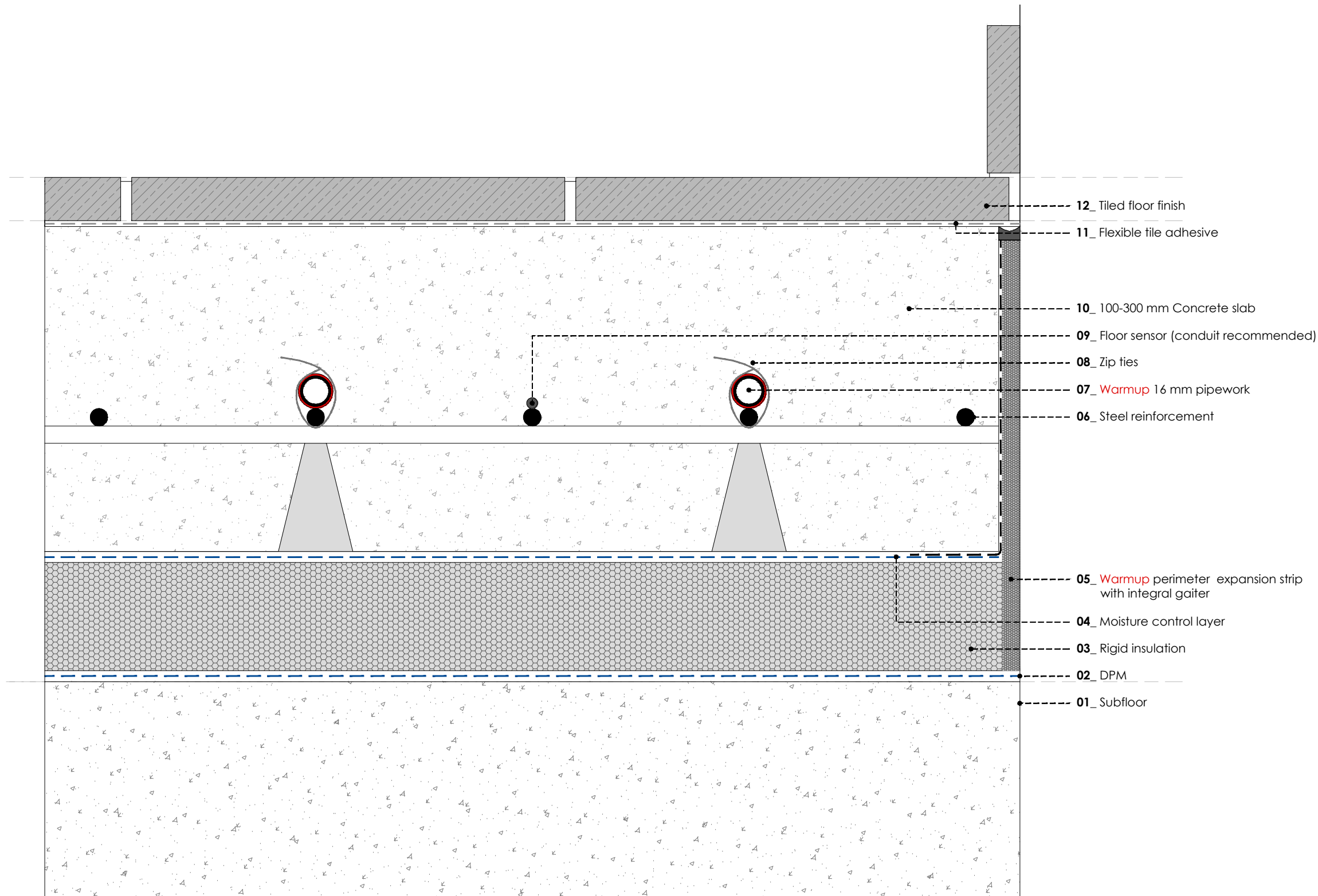

REV	DATE	DESCRIPTION	DR	CH



Warmup

The world's **best-selling** floor heating brand™

WARMUP PLC, 704 Tudor Estate, Abbey Road, London, NW10 7JW
Tel 0845 034 8270 Fax 0208 453 6869

cad@warmup.com projects@warmup.com www.warmup.co.uk

DRAWING ISSUE STATUS		DRAWING NO
CONSTRUCTION		02
PROJECT		
FORTE GRID SYSTEM CONCRETE SUBFLOOR		
TITLE		
TILED FLOOR DETAILED SECTION		
PROJECT MANAGER	DRAWN	CHECKED
	AA	AW
DATE	SCALE	REVISION
21.02.2017	1:50@A3	
CAD FILE		
20170221-H-FORTE-DET SECTIONS.DWG		

WARMUP FORTE GRID SYSTEM. Tiled floor

© This drawing is confidential and may not be used, copied or disclosed to anyone without permission of Warmup Plc. The Copyright of these drawings remain the property of Warmup Plc.

Do not scale from drawings, all dimensions to be checked on site.

The Warmup word and associated logos are trade marks. © Warmup Plc. 2010 - Regd. TM Nos. 1257757, 4409926, 5265707. E & OE. Registered in England No. 2955213.

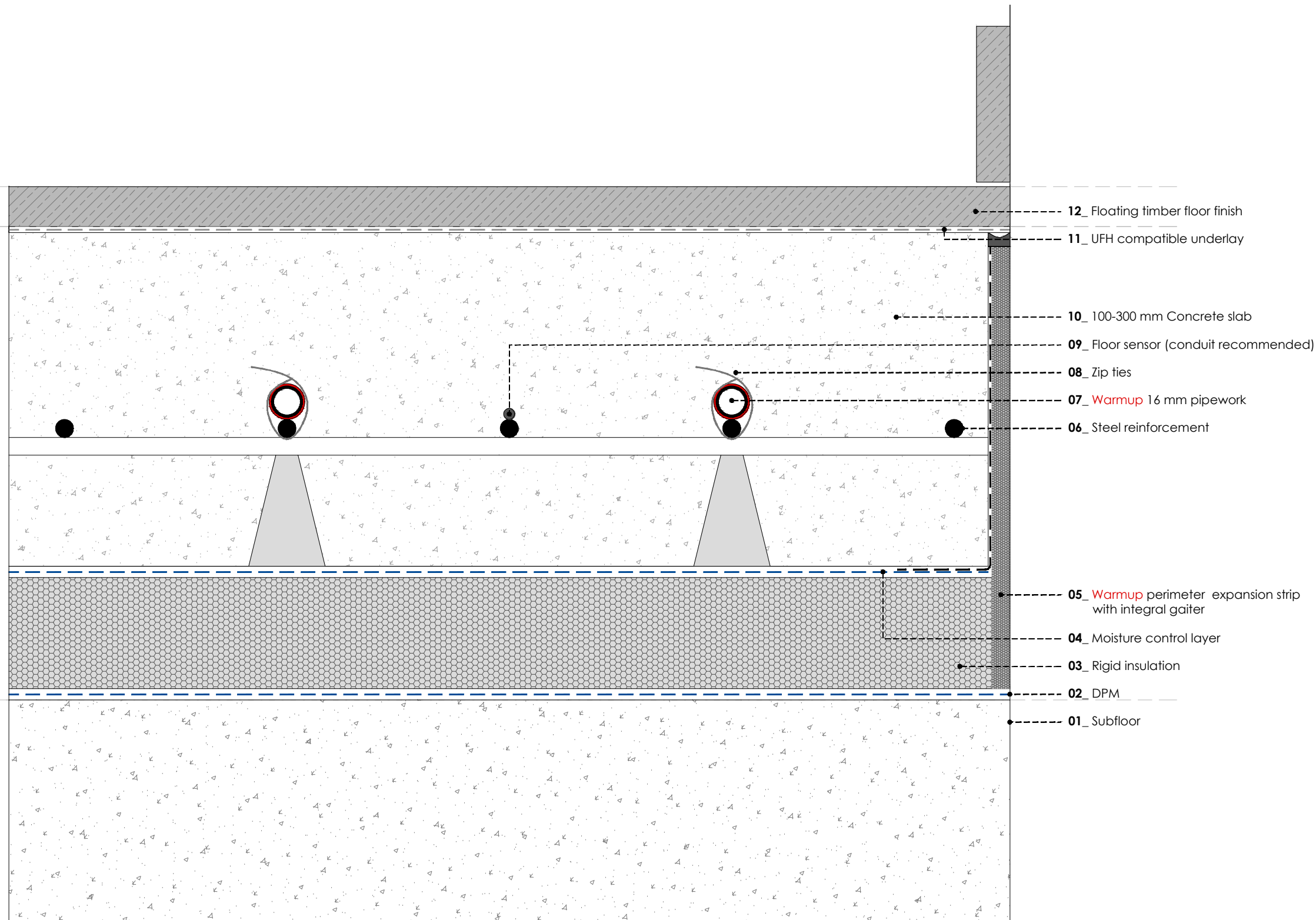

REV	DATE	DESCRIPTION	DR	CH



Warmup

The world's best-selling floor heating brand™

WARMUP PLC, 704 Tudor Estate, Abbey Road, London, NW10 7JW
 Tel 0845 034 8270 Fax 0208 453 6869
cad@warmup.com projects@warmup.com www.warmup.co.uk

DRAWING ISSUE STATUS		DRAWING NO
CONSTRUCTION		03
PROJECT		
FORTE GRID SYSTEM		
CONCRETE SUBFLOOR		
TITLE		
WOOD / LAMINATE FLOOR - FLOATING		
DETAILED SECTION		
PROJECT MANAGER	DRAWN	CHECKED
	AA	AW
DATE	SCALE	REVISION
21.02.2017	1:50@A3	
CAD FILE		
20170221-H-FORTE-DET SECTIONS.DWG		

WARMUP FORTE GRID SYSTEM. Wood / Laminate floor - floating

© This drawing is confidential and may not be used, copied or disclosed to anyone without permission of Warmup Plc. The Copyright of these drawings remain the property of Warmup Plc.

Do not scale from drawings, all dimensions to be checked on site.

The Warmup word and associated logos are trade marks. © Warmup Plc. 2010 - Regd. TM Nos. 1257757, 4409926, 5265707. E & OE. Registered in England No. 2955213.

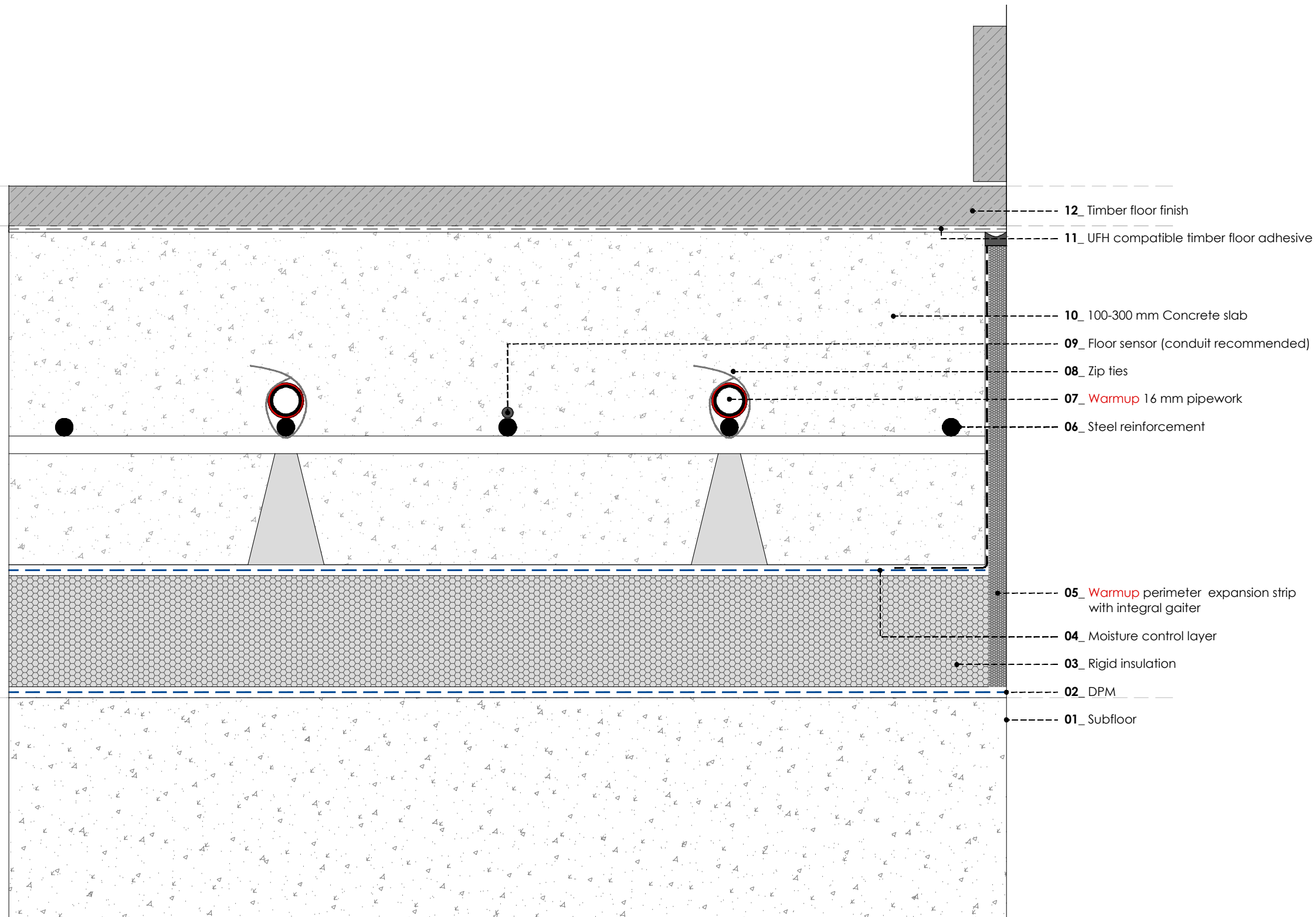

REV	DATE	DESCRIPTION	DR	CH



Warmup

The world's **best-selling** floor heating brand™

WARMUP PLC, 704 Tudor Estate, Abbey Road, London, NW10 7UW
 Tel 0845 034 8270 Fax 0208 453 6869
cad@warmup.com projects@warmup.com www.warmup.co.uk

DRAWING ISSUE STATUS		DRAWING NO
CONSTRUCTION		04
PROJECT		
FORTE GRID SYSTEM		
CONCRETE SUBFLOOR		
TITLE		
WOOD / LAMINATE FLOOR - GLUED		
DETAILED SECTION		
PROJECT MANAGER	DRAWN	CHECKED
	AA	AW
DATE	SCALE	REVISION
21.02.2017	1:50@A3	
CAD FILE		
20170221-H-FORTE-DET SECTIONS.DWG		

WARMUP FORTE GRID SYSTEM. Wood / Laminate floor - glued

© This drawing is confidential and may not be used, copied or disclosed to anyone without permission of Warmup Plc. The Copyright of these drawings remain the property of Warmup Plc.

Do not scale from drawings, all dimensions to be checked on site.

The Warmup word and associated logos are trade marks. © Warmup Plc. 2010 - Regd. TM Nos. 1257757, 4409926, 5265707. E & OE. Registered in England No. 2955213.

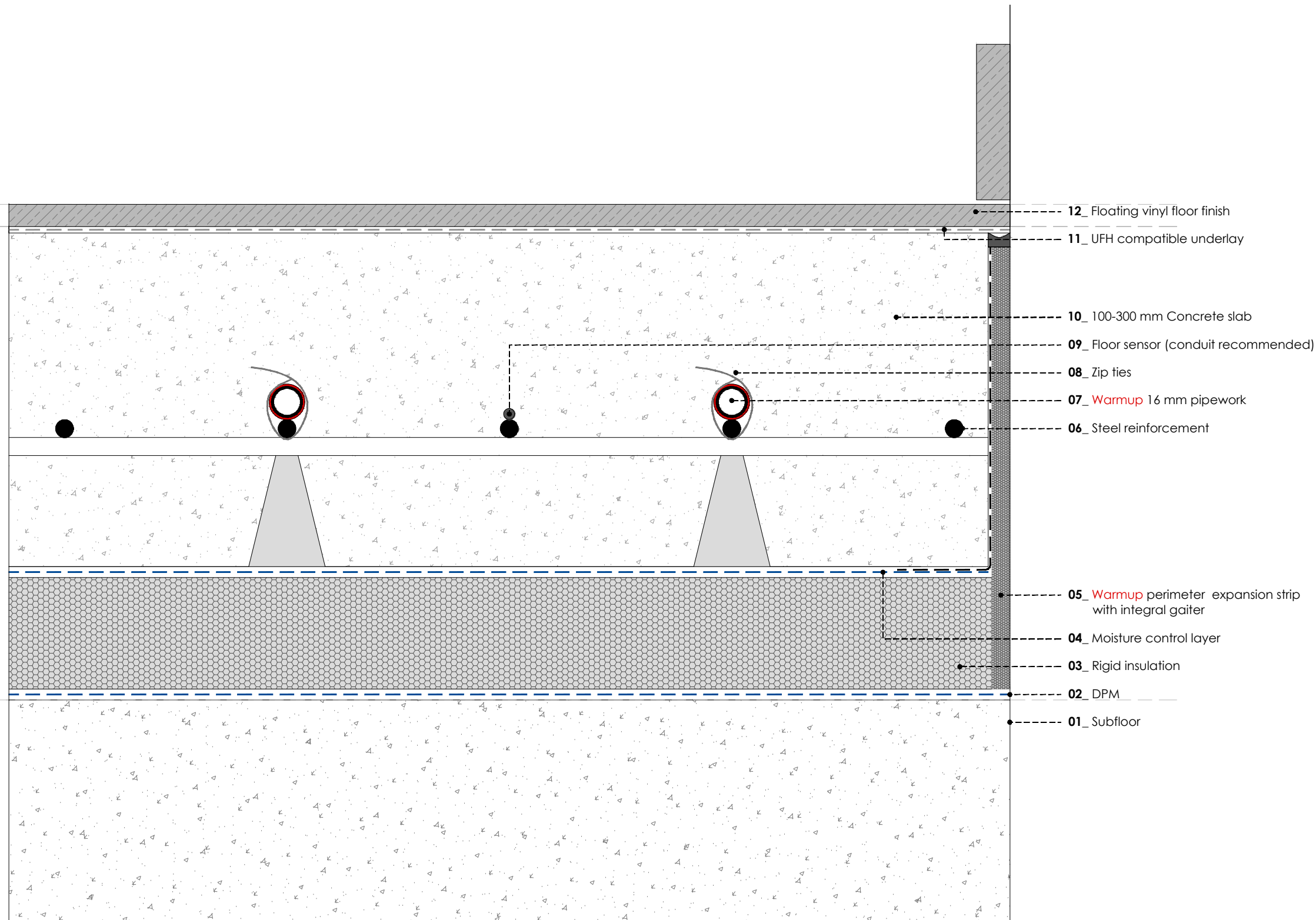

REV	DATE	DESCRIPTION	DR	CH



Warmup

The world's **best-selling** floor heating brand™

WARMUP PLC, 704 Tudor Estate, Abbey Road, London, NW10 7UW
 Tel 0845 034 8270 Fax 0208 453 6869
cad@warmup.com projects@warmup.com www.warmup.co.uk

DRAWING ISSUE STATUS		DRAWING NO
CONSTRUCTION		05
PROJECT		
FORTE GRID SYSTEM CONCRETE SUBFLOOR		
TITLE		
VINYL FLOOR - FLOATING DETAILED SECTION		
PROJECT MANAGER	DRAWN	CHECKED
	AA	AW
DATE	SCALE	REVISION
21.02.2017	1:50@A3	
CAD FILE		
20170221-H-FORTE-DET SECTIONS.DWG		

WARMUP FORTE GRID SYSTEM. Vinyl floor - floating

© This drawing is confidential and may not be used, copied or disclosed to anyone without permission of Warmup Plc. The Copyright of these drawings remain the property of Warmup Plc.

Do not scale from drawings, all dimensions to be checked on site.

The Warmup word and associated logos are trade marks. © Warmup Plc. 2010 - Regd. TM Nos. 1257757, 4409926, 5265707. E & OE. Registered in England No. 2955213.

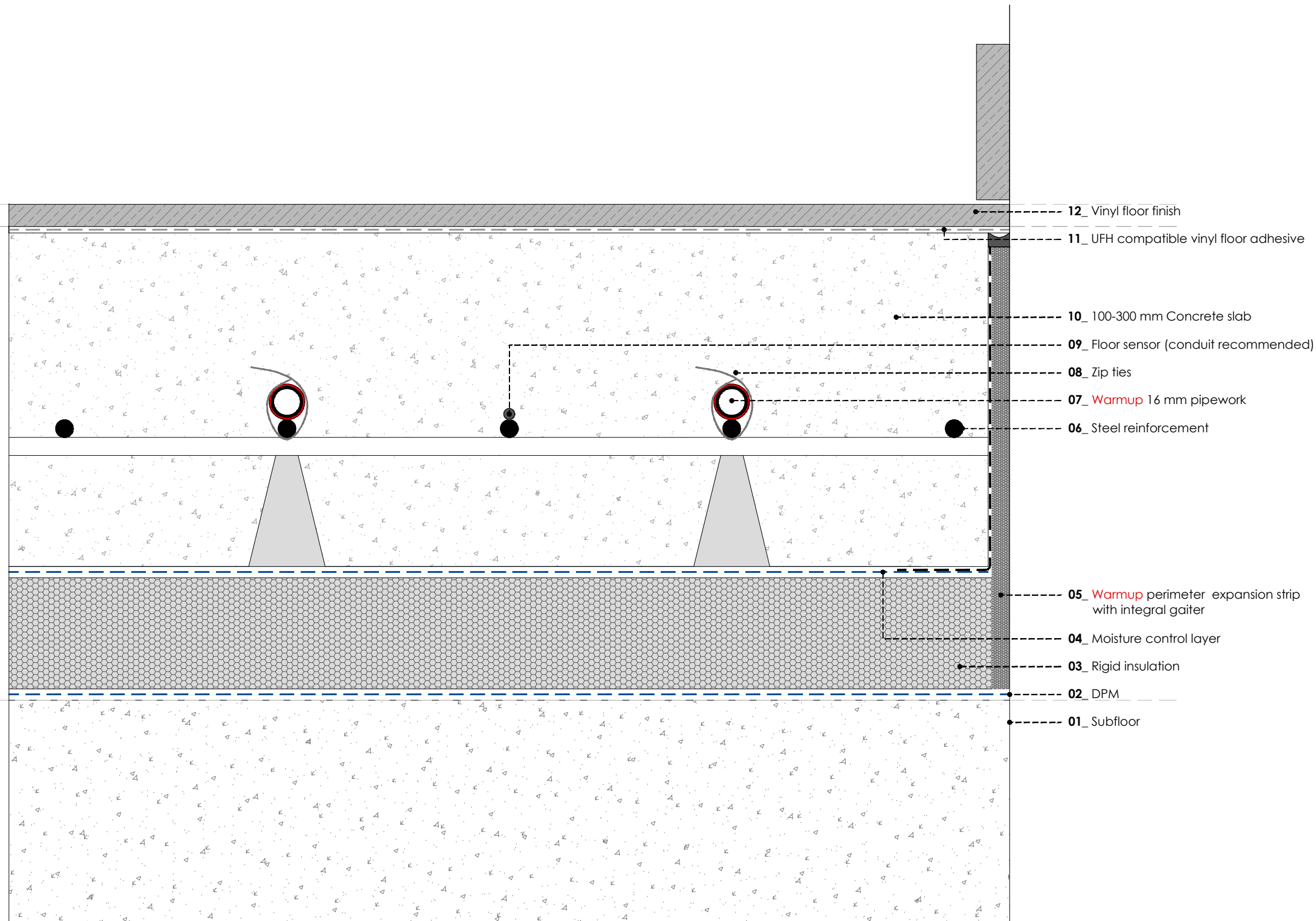

REV	DATE	DESCRIPTION	DR	CH



Warmup

The world's **best-selling** floor heating brand™

WARMUP PLC, 704 Tudor Estate, Abbey Road, London, NW10 7UW
 Tel 0845 034 8270 Fax 0208 453 6869
cad@warmup.com projects@warmup.com www.warmup.co.uk

DRAWING ISSUE STATUS		DRAWING NO
CONSTRUCTION		06
PROJECT		
FORTE GRID SYSTEM CONCRETE SUBFLOOR		
TITLE		
VINYL FLOOR - GLUED DETAILED SECTION		
PROJECT MANAGER	DRAWN	CHECKED
	AA	AW
DATE	SCALE	REVISION
21.02.2017	1:50@A3	
CAD FILE		
20170221-H-FORTE-DET SECTIONS.DWG		

WARMUP FORTE GRID SYSTEM. Vinyl floor - glued

© This drawing is confidential and may not be used, copied or disclosed to anyone without permission of Warmup Plc. The Copyright of these drawings remain the property of Warmup Plc.

Do not scale from drawings, all dimensions to be checked on site.
 The Warmup word and associated logos are trade marks. © Warmup Plc. 2010 - Regd. TM Nos. 1257757, 4409926, 5265707. E & OE. Registered in England No. 2955213.

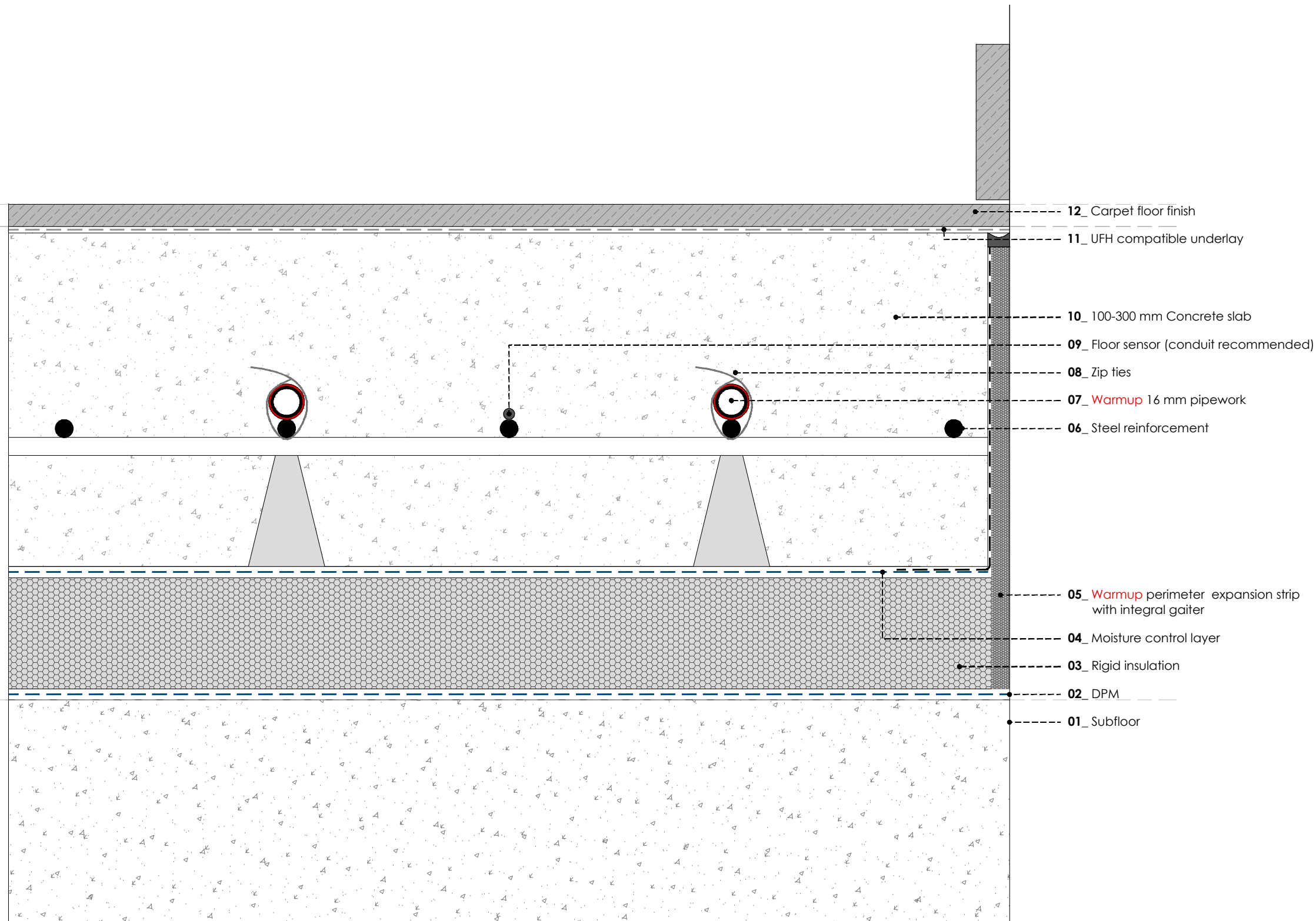

REV	DATE	DESCRIPTION	DR	CH



Warmup

The world's **best-selling** floor heating brand™

WARMUP PLC, 704 Tudor Estate, Abbey Road, London, NW10 7JW
Tel 0845 034 8270 Fax 0208 453 6869

cad@warmup.com projects@warmup.com www.warmup.co.uk

DRAWING ISSUE STATUS		DRAWING NO
CONSTRUCTION		07
PROJECT		
FORTE GRID SYSTEM CONCRETE SUBFLOOR		
TITLE		
CARPET FLOOR DETAILED SECTION		
PROJECT MANAGER	DRAWN	CHECKED
	AA	AW
DATE	SCALE	REVISION
21.02.2017	1:50@A3	

CAD FILE
20170221-H-FORTE-DET SECTIONS.DWG

© This drawing is confidential and may not be used, copied or disclosed to anyone without permission of Warmup Plc. The Copyright of these drawings remain the property of Warmup Plc.

Do not scale from drawings, all dimensions to be checked on site.

The Warmup word and associated logos are trade marks. © Warmup Plc. 2010 - Regd. TM Nos. 1257757, 4409926, 5265707. E & OE. Registered in England No. 2955213.

WARMUP FORTE GRID SYSTEM. Vinyl floor - glued

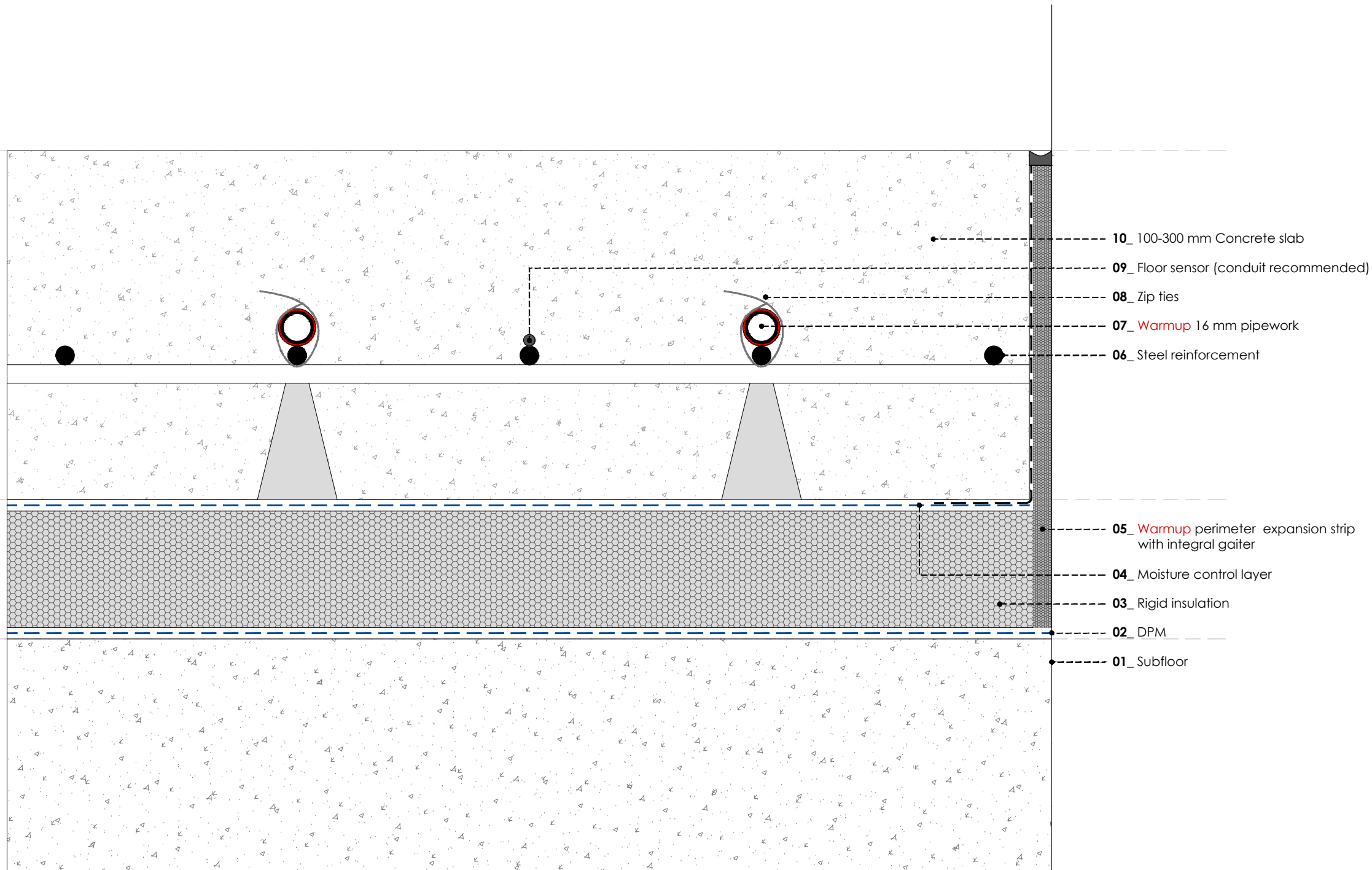

- 10_ 100-300 mm Concrete slab
- 09_ Floor sensor (conduit recommended)
- 08_ Zip ties
- 07_ Warmup 16 mm pipework
- 06_ Steel reinforcement

- 05_ Warmup perimeter expansion strip with integral gaiter
- 04_ Moisture control layer
- 03_ Rigid insulation
- 02_ DPM
- 01_ Subfloor

REV	DATE	DESCRIPTION	DR	CH



Warmup

The world's best-selling floor heating brand™
 WARMUP PLC, 704 Tudor Estate, Abbey Road, London, NW10 7UW
 Tel 0845 034 8270 Fax 0208 453 6869
cad@warmup.com projects@warmup.com www.warmup.co.uk

DRAWING ISSUE STATUS		DRAWING NO
CONSTRUCTION		08
PROJECT		
FORTE GRID SYSTEM CONCRETE SUBFLOOR		
TITLE		
CONCRETE FLOOR DETAILED SECTION		
PROJECT MANAGER	DRAWN	CHECKED
	AA	AW
DATE	SCALE	REVISION
21.02.2017	1:50@A3	
CAD FILE		
20170221-H-FORTE-DET SECTIONS.DWG		

WARMUP FORTE GRID SYSTEM. Concrete floor

© This drawing is confidential and may not be used, copied or disclosed to anyone without permission of Warmup Plc. The Copyright of these drawings remain the property of Warmup Plc.
 Do not scale from drawings, all dimensions to be checked on site.
 The Warmup word and associated logos are trade marks. © Warmup Plc. 2010 - Regd. TM Nos. 1257757, 4409926, 5265707. E & OE. Registered in England No. 2955213.